



September 29, 2015

Patrick Baird, Archaeologist, THPO
Nez Perce Tribe, Cultural Resource Program
PO Box 365
Lapwai, ID 83540

Subject: Historic preservation concerns at 2/317 West 6th Street, Moscow, Idaho 83843

Dear Ms. Wagner:

The Moscow Urban Renewal Agency (MURA) will be conducting environmental remediation activities on property owned by the MURA located at 2/317 West 6th Street, Moscow, Latah County, Idaho 83843. The property is approximately 0.87 acres in size and is zoned CB (Central Business District). The site is located at latitude 46.72991 and longitude -117.00313. The surrounding land uses are commercial/industrial.

The selected environmental remediation activities proposed to take place at the site include target soil removals in conjunction with biodegradation and the installation of a shallow groundwater pump and treat system. Attached to this letter are the construction plans which highlight the area of proposed environmental remediation activities. Also attached to the letter is an "Inadvertent Discovery Protocol" that the parties will follow in the conduct of the excavation activities.

The MURA are requesting a determination letter as to whether or not there are any historic concerns your office might have with regard to the proposed environmental remediation activities. If you have any questions or comments, please feel free to call me at (208) 883-7011 or email at bbelknap@ci.moscow.id.us. If you wish to contact our funding agency regarding this proposed project, please contact Terri Griffith at (206)553-8511 or email at Griffith.Terri@epamail.epa.gov.

Sincerely,

A handwritten signature in blue ink, appearing to read "Bill Belknap", is written over a light blue horizontal line.

Bill Belknap
Executive Director

Enclosures: 2

PO Box 9203
206 E Third Street
Moscow ID 83843
P: 208-883-7011
F: 208-883-7034
www.ci.moscow.id.us/ura

6th & JACKSON BROWNFIELDS EXCAVATION CITY OF MOSCOW LATAH COUNTY, IDAHO SEPTEMBER 2015

ENGINEER:
TERRAGRAPHS ENVIRONMENTAL
ENGINEERING, INC.
108 W. IDAHO AVENUE
KELLOGG, IDAHO 83837
TELEPHONE: (208) 786-1206



PROJECT SPONSORS:

CITY OF MOSCOW
208 E. 3rd Street
MOSCOW, ID 83846



**MOSCOW URBAN
RENEWAL AGENCY**
208 E. 3rd Street
MOSCOW, ID 83843

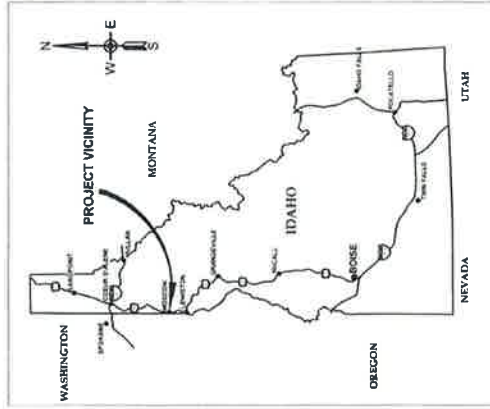

SHEET #	SHEET NAME	SHEET REFERENCE
1	COVER SHEET	CS
2	EXCAVATION PLAN	C1
3	CROSS SECTIONS	C2
4	BACKFILL PLAN	C3
5	SEWER CONNECTION DETAILS	D1



CONSTRUCTION SET

NO.	DATE	REVISIONS	BY	CHK	DATE



6TH & JACKSON BROWNFIELDS
EXCAVATION
MOSCOW, IDAHO

COVER SHEET

SHEET NAME:	CS
DATE:	09/02/2015
PROJECT NO.:	14072
SHEET:	1 OF 5

CALL BEFORE YOU DIG
1-800-398-3285

NOTES:
1. THE EXISTING UTILITY LOCATIONS SHOWN ON THIS DRAWING ARE BASED ON RECORD DRAWINGS AND FIELD SURVEY. THE CONTRACTOR SHALL VERIFY THE LOCATION AND DEPTH OF ALL UTILITIES PRESENT AT THE SITE. IT IS THE CONTRACTOR'S RESPONSIBILITY TO LOCATE AND PROTECT ALL ABOVE-GRADE AND BELOW-GRADE UTILITIES.
2. ALL DISTURBED AREAS SHALL BE RESTORED WITH 4" THICK 3/4" TO 1" AGGREGATE.

INSTALL 6" PVC SANITARY SEWER SERVICE
EXTEND INTO SITE
APPROXIMATELY 10' BEYOND BACK OF SIDEWALK

REPAIR STREET AND SIDEWALK IN
ACCORDANCE WITH CITY OF MOSCOW
STANDARD DRAWING NUMBERS 7 AND 34

PROTECT AND RETAIN
GAS VALVE

CUT AND CAP
WATER LINE AS NECESSARY

UTILITY POLE AND GUY
TO BE RELOCATED BY OTHERS

APPROXIMATE
EXCAVATION LIMITS

SUSPECTED BRICK TUNNEL
TO BE REMOVED
APPROXIMATE DEPTH
5.0' - 9.5' BELOW GROUND

2' OVEREXCAVATION BUFFER

UNDERGROUND POWER TO BE LOCATED BY CONTRACTOR
PROTECT AND RETAIN

LEGEND

- AREAS TO BE EXCAVATED
15 FEET BELOW SURFACE OR
UNTIL GROUNDWATER IS
ENCOUNTERED
- AREAS TO BE SLOPED PER OSHA
REQUIREMENTS
- MONITORING WELLS TO BE REMOVED
- UTILITY POLE
- UTILITY GUY
- GAS VALVE
- FIRE HYDRANT
- SANITARY SEWER MANHOLE
- WATER LINE
- OVERHEAD POWER LINE
- UNDERGROUND POWER LINE
- 20" SANITARY SEWER LINE
- APPROXIMATE PARCEL BOUNDARY

CONSTRUCTION SET

NO.	DATE	REVISIONS	BY	CHK	DATE

DRAWN BY:	D. GILLEN	COORDINATE SYSTEM:	UTM, NAD 83, U.S. FT., WEST
ENGINEER:	D. GILLEN	SCALE:	1" = 25'
CHECKED:	D. FORSBETH	APPROVED:	D. FORSBETH
DATE:	09/02/2015	DATE:	09/02/2015



TerraGraphics
Environmental Engineering, Inc.

6TH & JACKSON BROWNFIELDS
EXCAVATION
MOSCOW, IDAHO

EXCAVATION PLAN

SHEET NAME:	CL
DATE:	08/02/2015
PROJECT NO.:	14022
SHEET:	2 OF 5

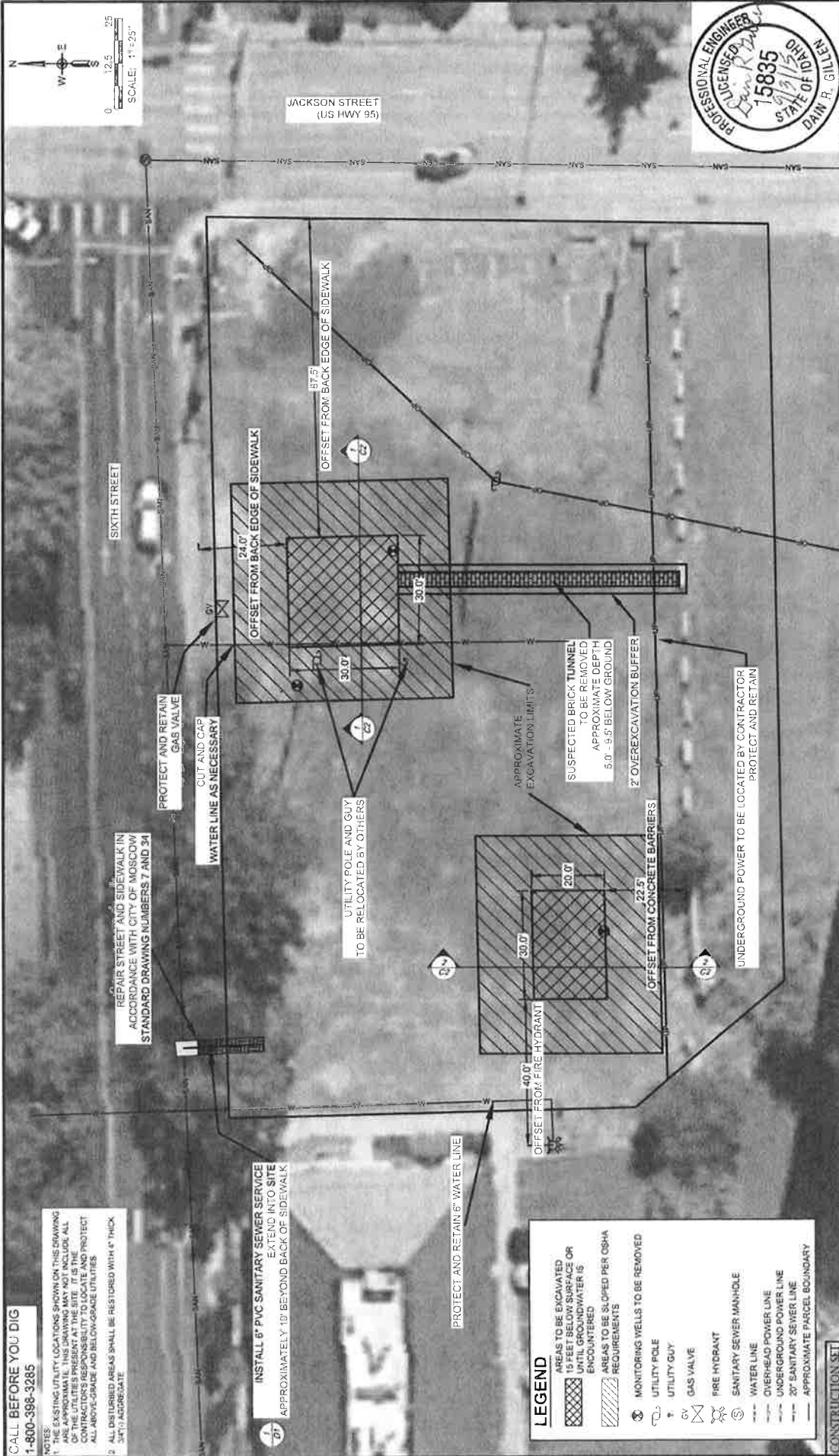
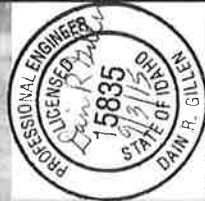

- NOTES:
1. AREAS SHALL BE EXCAVATED TO 15 FEET DEPTH, OR UNTIL GROUNDWATER IS ENCOUNTERED, OR AS DIRECTED BY THE ENGINEER.
 2. EXCAVATED AREAS SHALL BE SLOPED AT 1H:1V PER OSHA REQUIREMENTS FOR TYPE 'B' SOIL.

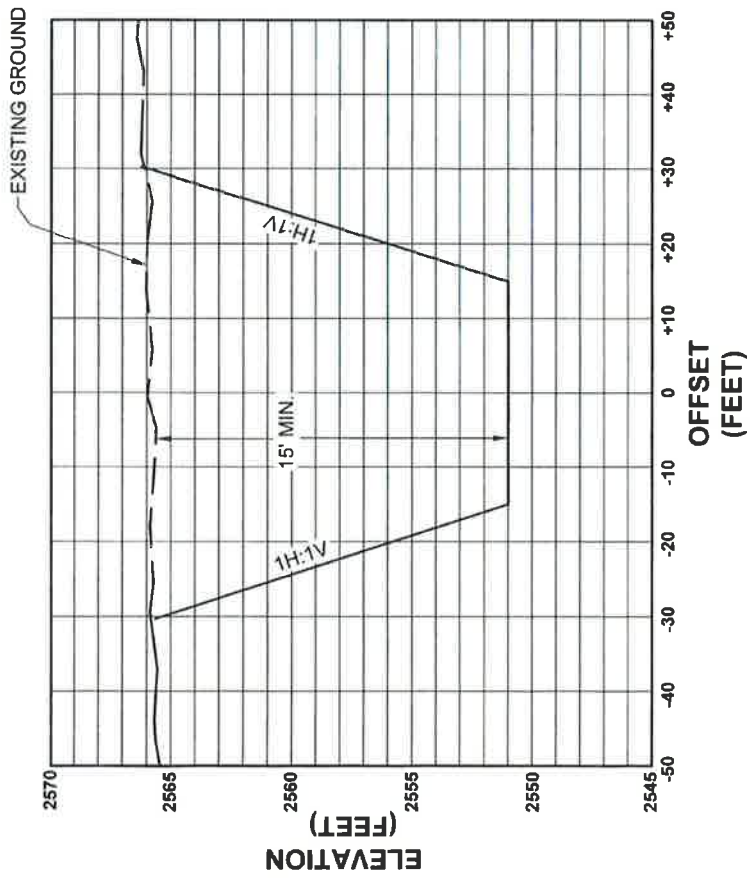

7
NORTHEAST EXCAVATION AREA
TYPICAL SECTION
VERTICAL EXAGGERATION 3:2:1

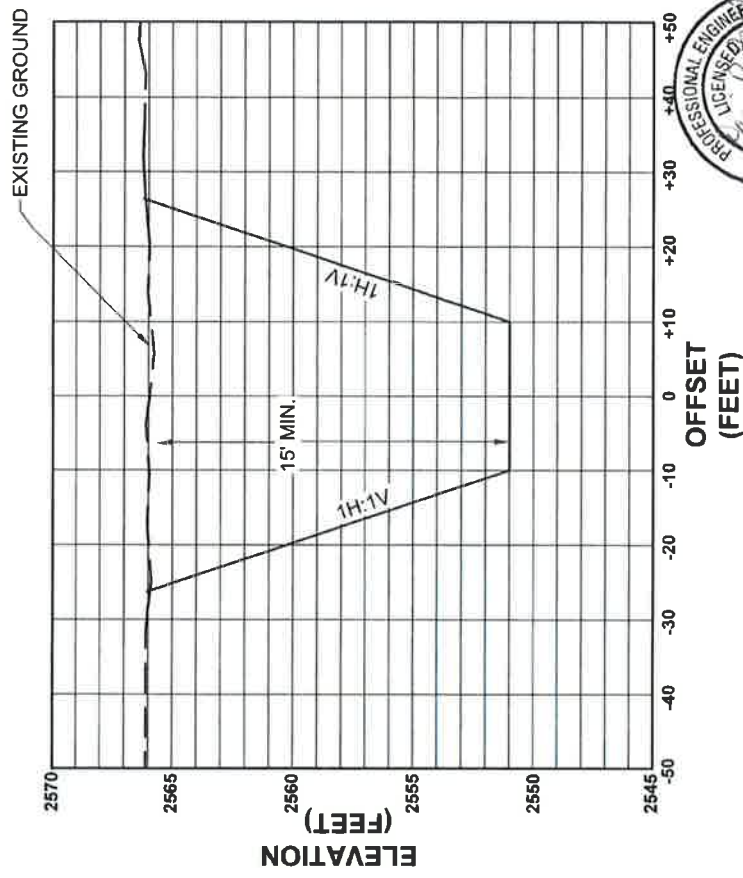

2
SOUTHWEST EXCAVATION AREA
TYPICAL SECTION
VERTICAL EXAGGERATION 3:2:1

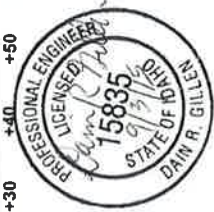

SHEET NAME:	C2
DATE:	08/02/2015
PROJECT NO.:	1472
SHEET:	3 OF 5

6TH & JACKSON BROWNFIELDS EXCAVATION	CROSS SECTIONS
MOSCOW, IDAHO	



CONSTRUCTION SET	
DRAWN BY:	D. GILLEN
ENGINEER:	D. GILLEN
CHECKED:	D. FORSETH
DATE:	08/02/2015
APPROVED:	D. FORSETH
DATE:	08/02/2015
COORDINATE SYSTEM:	NAD 83, 10 FT. WEST
SCALE:	N.T.S.

NO.	DATE	REVISIONS	BY	CHK	DATE

NOTE: ALL BACKFILL MATERIAL SHALL BE COMPACTED TO AT LEAST 95%
 MAXIMUM DENSITY ACCORDING TO MODIFIED PROCTOR

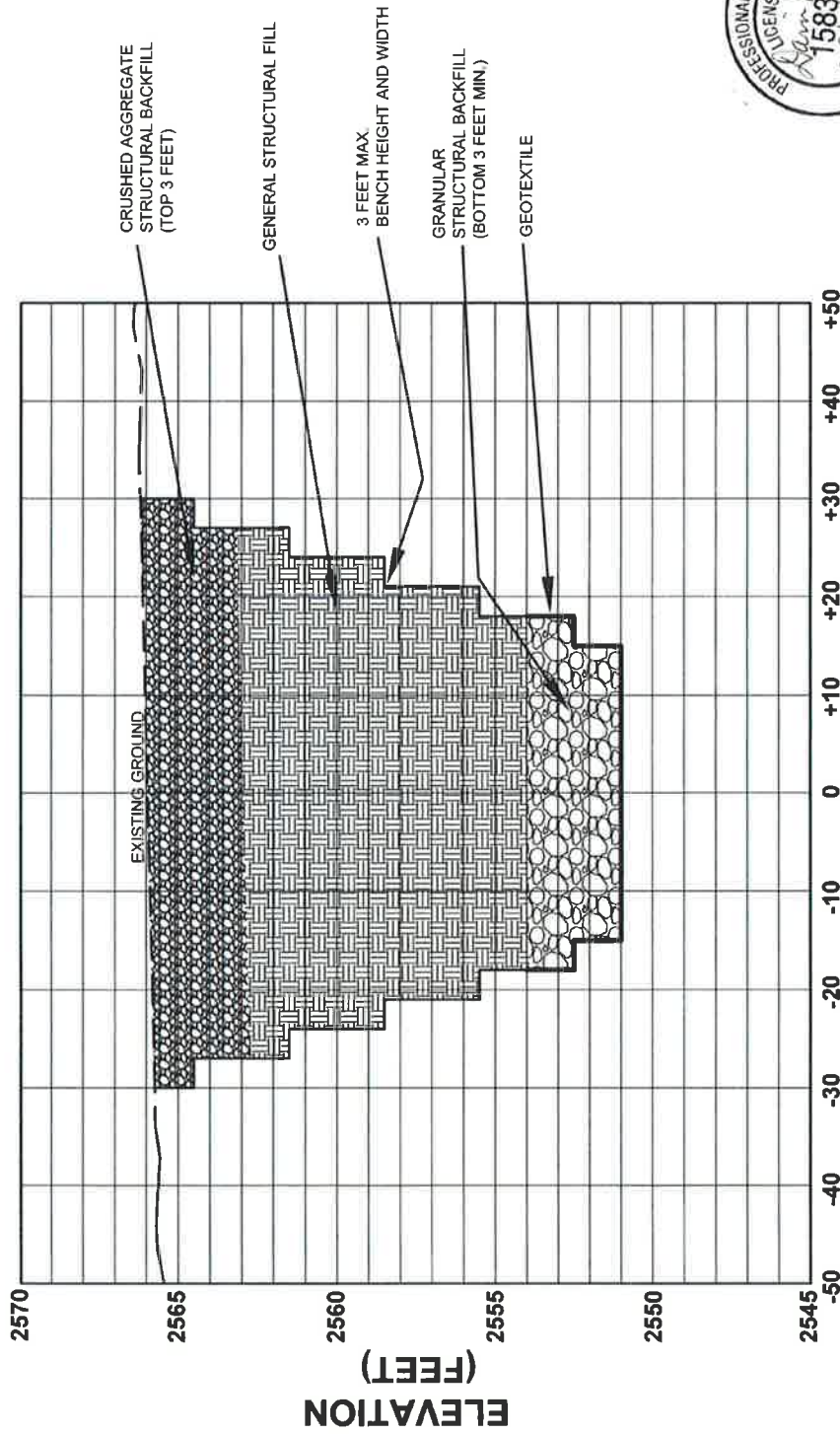

TYPICAL BACKFILL PLAN
 VERTICAL EXAGGERATION 3.2:1



SHEET NAME:	C3
DATE:	09/03/2015
PROJECT NO:	14072
SHEET:	4 OF 5

BACKFILL PLAN

6TH & JACKSON BROWNFIELDS
 EXCAVATION
 MOSCOW, IDAHO



COORDINATE SYSTEM:	WEST
SCALE:	N.T.S.
APPROVED:	D. FORSETH
DATE:	09/03/2015

DRAWN BY:	D. GILLEN
ENGINEER:	D. GILLEN
CHECKED:	D. FORSETH
DATE:	09/02/2015

NO.	DATE	REVISIONS

CONSTRUCTION SET

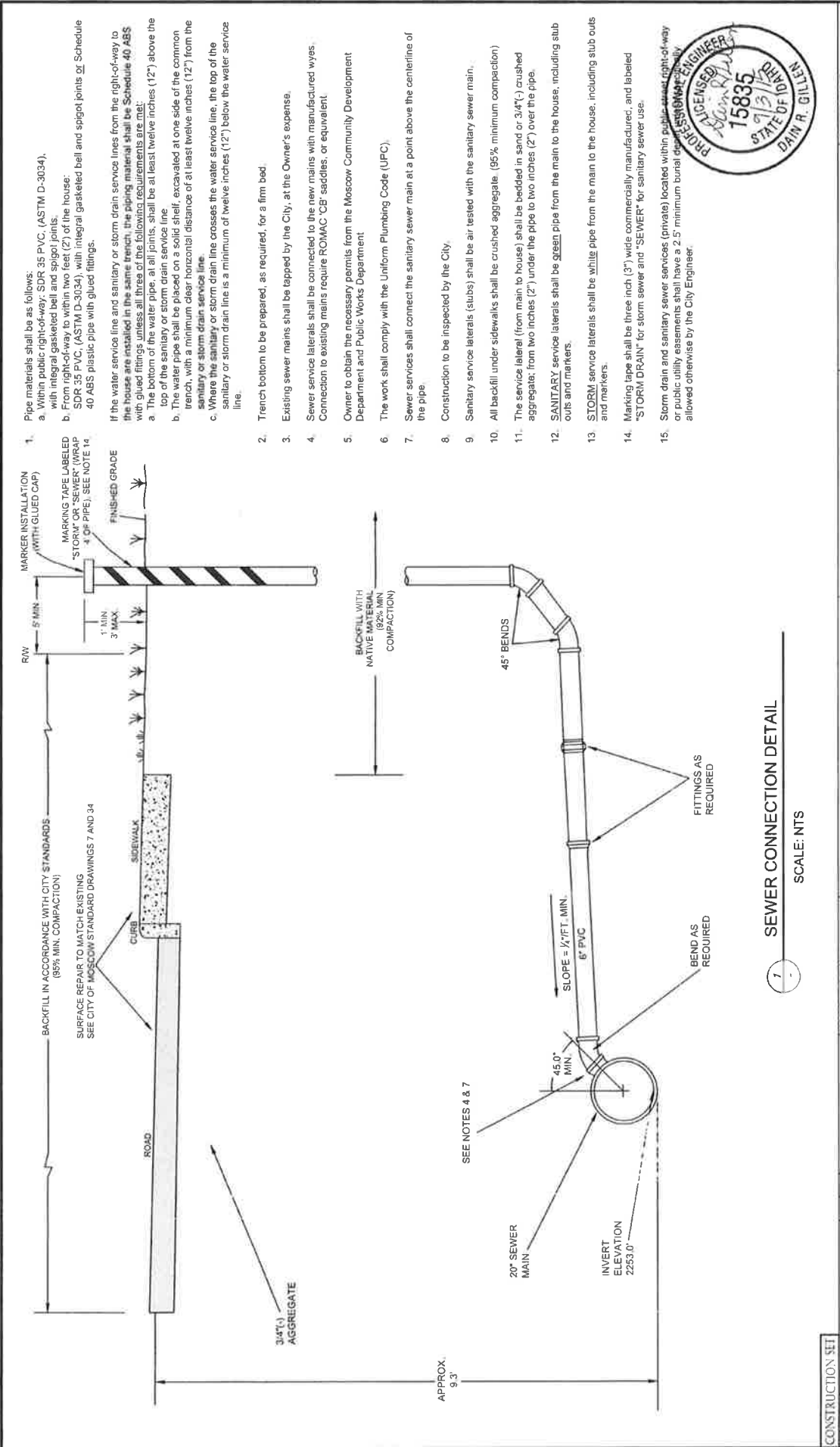

DRAWN BY		D. GILLEN	COORDINATE SYSTEM	6TH & JACKSON BROWNFIELDS EXCAVATION		SEWER CONNECTION		SHEET NAME:	
ENGINEER		D. GILLEN	SCALE	MOSCOW, IDAHO		DATE		D1	
CHECKED		D. FORSBETH	APPROVED	MOSCOW, IDAHO		PROJECT NO.		09/02/2015	
DATE		09/02/2015	DATE	MOSCOW, IDAHO		SHEET		15872	
BY		D. FORSBETH	DATE	MOSCOW, IDAHO		SHEET		5 OF 5	
REVISIONS			DATE	MOSCOW, IDAHO		SHEET		5 OF 5	

CONSTRUCTION SET

TerraGraphics
 Environmental Engineering, Inc.

SEWER CONNECTION DETAIL
 SCALE: NTS



- Pipe materials shall be as follows:
 - Within public right-of-way, SDR 35 PVC, (ASTM D-3034), with integral gasketed bell and spigot joints.
 - From right-of-way to within two feet (2') of the house, SDR 35 PVC, (ASTM D-3034), with integral gasketed bell and spigot joints or Schedule 40 ABS plastic pipe with glued fittings.

If the water service line and sanitary or storm drain service lines from the right-of-way to the house are installed in the same trench, the piping material shall be Schedule 40 ABS with glued fittings unless all three of the following requirements are met:

 - The bottom of the water pipe, at all joints, shall be at least twelve inches (12") above the top of the sanitary or storm drain service line.
 - The water pipe shall be placed on a solid shelf, excavated at one side of the common trench, with a minimum clear horizontal distance of at least twelve inches (12") from the sanitary or storm drain service line.
 - Where the sanitary or storm drain line crosses the water service line, the top of the sanitary or storm drain line is a minimum of twelve inches (12") below the water service line.
- Trench bottom to be prepared, as required, for a firm bed.
- Existing sewer mains shall be tapped by the City, at the Owner's expense.
- Sewer service laterals shall be connected to the new mains with manufactured wyes. Connection to existing mains require ROMAC "CB" saddles, or equivalent.
- Owner to obtain the necessary permits from the Moscow Community Development Department and Public Works Department.
- The work shall comply with the Uniform Plumbing Code (UPC).
- Sewer services shall connect the sanitary sewer main at a point above the centerline of the pipe.
- Construction to be inspected by the City.
- Sanitary service laterals (stubs) shall be air tested with the sanitary sewer main.
- All backfill under sidewalks shall be crushed aggregate (95% minimum compaction).
- The service lateral (from main to house) shall be bedded in sand or 3/4" crushed aggregate, from two inches (2") under the pipe to two inches (2") over the pipe.
- SANITARY service laterals shall be green pipe from the main to the house, including stub outs and markers.
- STORM service laterals shall be white pipe from the main to the house, including stub outs and markers.
- Marking tape shall be three inch (3") wide commercially manufactured, and labeled "STORM DRAIN" for storm sewer and "SEWER" for sanitary sewer use.
- Storm drain and sanitary sewer services (private) located within public street right-of-way or public utility easements shall have a 2.5' minimum burial depth, as shown, and shall be allowed otherwise by the City Engineer.

Inadvertent Discovery Plan for Cultural Resources

Protocol for coordination in the event of inadvertent discovery:

- In the event of an inadvertent discovery of possible archaeological materials, all work will stop immediately in the vicinity of the find.
- The area will be secured and protected.
- The Project Manager will be notified. The Project Manager will notify the State Historic Preservation Office (SHPO). If possible human remains are encountered, the Idaho State Police, SHPO, and Tribes will also be notified.
- No work may resume until the consulting Archaeologist are on-site and able to assess the situation.
- If human remains are encountered, do not disturb them in any way. *Do not call 911*. Do not speak with the media. Secure the location. Do not take Photos.
- The Project Manager will consult with SHPO and appropriate Tribal Governments and determine an appropriate course of action.
- Additional archaeological excavations may be required. This is handled on a case by case basis by the consulting Archaeologist in consultation with SHPO and appropriate Tribal Governments.

When to stop work:

Construction work may uncover previously unidentified Native American or Euro-American artifacts. This may occur for a variety of reasons, but may be associated with access restrictions during project development, or if the area contains impervious surfaces throughout most of the project area which would have prevented standard archaeological site discovery methods.

Work must stop when the following types of artifacts and/or features are encountered:

Native American artifacts may include (but are not limited to):

- Flaked stone tools (arrowheads, knives scrapers etc.)
- Waste flakes that resulted from the construction of flaked stone tools.
- Ground stone tools like mortars and pestles.
- Layers (strata) of discolored earth resulting from fire hearths. May be black, red or mottled brown and often contain discolored cracked rocks or dark soil with broken shell
- Human remains
- structural remains- wooden beams, post holes, fish weirs

Euro-American artifacts may include (but are not limited to):

- Glass (from bottles, vessels, windows etc.)
- Ceramic (from dinnerware, vessels etc.)

- Metal (nails, drink/food cans, tobacco tins, industrial parts etc.)
- Old Wooden Posts, pilings, or planks (these may be encountered above or below water)
- Remains of ships or sea-going vessels, marine hardware etc.
- Old farm equipment may indicate historic resources in the area

Contacts:

POSITION	NAME	WORK PHONE	CELL
Project Mgr.	Bill Belknap	208.883.7011	208.310.3517
Project Engineer	Darin Gillen, P.E.	208.786.1206	
SHPO	Ethan Morton	208.334.3847	
Nez Perce Tribe	Patrick Baird	208.843.7400 x.2342	208.791.8610
Coeur d'Alene Tribe	Jill Maria Wagner	208.686.1572	

Proceeding with Construction

- Construction can proceed only after the proper archaeological inspections have occurred and environmental clearances are obtained. This requires close coordination with SHPO, FHWA and the Tribes.
- After an inadvertent discovery, some areas may be specified for close monitoring or 'no work zones.' Any such areas will be identified to the Project Manager, and appropriate Contractor personnel.
- In coordination with the consulting Archaeologist, the Project Manager will verify these identified areas by engineer's station if available, mark them on site if appropriate.