

CITY OF MOSCOW SLAB INSULATION REQUIREMENTS

There are several ways that insulation may be installed on the slab edge. Slab edge insulation may be placed on the inside of the foundation stem wall or on the exterior of the wall. The insulation must extend from the top of the slab downward or downward and horizontally for the required minimum distance. Insulation that extends horizontally away from the slab must be covered by pavement or at least 10 in. of soil. The top edge of slab insulation installed between the exterior wall and the interior slab can be cut at a 45 degree angle away from the exterior wall, see Figure 94. Check the plans and compliance documentation to determine the depth. It is critical that slab insulation is installed from the top of the slab edge down. Most of the heat loss from the slab is lost through the top portion of the slab edge exposed to the outside air..

Slab edge insulation can be installed on the inside of the stem wall or on the exterior of the slab as shown in Figure 95. The code also requires that exterior slab edge insulation that is exposed to air be covered with a rigid, opaque and weather-resistant protective covering. This cover will prevent the degradation of the insulation's thermal performance. The cover must extend 6 inches below the grade. Materials that can be used include exterior grade plastic, fiberglass, galvanized metal or aluminum flashing or a cementitious coating.

Insulation can be horizontal, vertical,
Or both. We require 24" of R-10. It
Can be placed shallow under the fill.
We also require a thermal break between
The foundation wall and the slab 1/2"
Minimum.

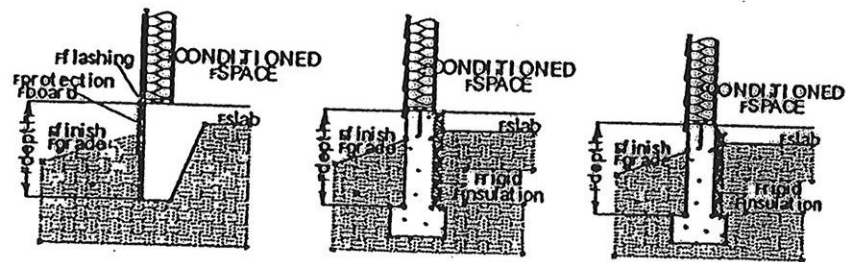

INSULATION DETAIL

